

DATE: 11 April 2019
DESIGNER: Graham Sheehan
PROJECT No: SES 04419
PROJECT NAME: Clongriffin Master Plan Gerard Gannon Properties



Designed in accordance with BS5489-1:2015 Class P4

Outdoor Lighting Report

PREPARED BY: Sabre Electrical Services Ltd.
Unit 11 Bellevue Ind. Est.
Finglas
Dublin 11.
e-mail: graham@sabrelighting.ie
Ph:01 8110875

Layout Report

General Data

Dimensions in Metres Angles in Degrees

Calculation Grids

ID	Grid Name	X	Y	X' Length	Y' Length	X' Spacing	Y' Spacing
1	Grid 1	739.00	744.00	373.00	376.00	1.49	1.50
2	Grid 2	678.00	533.00	290.00	211.00	1.50	1.50

Luminaires

Luminaire A Data



Supplier	C U Phosco
Type	P852-12-R2B-NW-CB0450-18W
Lamp(s)	740C NW
Lamp Flux (klm)	2.28
File Name	P852-12-R2B-NW-CB0450-18W.ies
Maintenance Factor	0.80
Imax70,80,90(cd/klm)	669.5, 62.5, 5.9
No. in Project	14

Luminaire B Data



Supplier	C U Phosco
Type	P852-12-F2-NW-CB0900-34W
Lamp(s)	740C NW
Lamp Flux (klm)	4.04
File Name	P852-12-F2-NW-CB0900-34W.ies
Maintenance Factor	0.80
Imax70,80,90(cd/klm)	761.9, 260.5, 34.9
No. in Project	71

Luminaire C Data



Supplier	Philips
Type	BDS650 VH ECO50/- No
Lamp(s)	ECO50-2S/740
Lamp Flux(klm)/Colour	5.49 -/
File Name	BDS650 1xECO50-2S_740 VH.Idt
Maintenance Factor	0.80
Imax70,80,90(cd/klm)	121.4, 85.7, 55.0
No. in Project	24

Luminaire D Data



Supplier	C U Phosco
Type	P567-3
Lamp(s)	100W SON-T
Lamp Flux (klm)	10.70
File Name	p567-3-100wson-t.cib
Maintenance Factor	0.80
Imax70,80,90(cd/klm)	218.5, 31.5, 7.0
No. in Project	8

Layout

ID	Type	X	Y	Height	Angle	Tilt	Cant	Out-reach	Target X	Target Y	Target Z
1	A	781.71	820.44	6.00	340.00	5.00	0.00	0.40			
2	B	832.17	929.22	6.00	254.00	5.00	0.00	0.40			
3	B	864.79	923.45	6.00	255.00	5.00	0.00	0.40			
4	B	889.18	915.17	6.00	255.00	5.00	0.00	0.40			
5	B	914.59	908.78	6.00	255.00	5.00	0.00	0.40			
6	C	876.91	963.60	5.00	232.00	0.00	0.00	0.00			
7	C	911.57	955.77	5.00	278.00	0.00	0.00	0.00			
8	B	854.07	1095.61	6.00	254.00	5.00	0.00	0.40			
9	A	808.57	915.66	6.00	335.00	5.00	0.00	0.40			

Layout Continued

ID	Type	X	Y	Height	Angle	Tilt	Cant	Out-reach	Target X	Target Y	Target Z
10	B	945.90	906.22	6.00	270.00	5.00	0.00	0.40			
11	B	977.39	907.18	6.00	272.00	5.00	0.00	0.40			
12	B	1007.41	908.24	6.00	269.00	5.00	0.00	0.40			
13	B	796.67	816.17	6.00	246.00	5.00	0.00	0.40			
14	B	820.05	805.41	6.00	246.00	5.00	0.00	0.40			
15	B	844.33	794.26	6.00	251.00	5.00	0.00	0.40			
16	B	845.67	770.17	6.00	329.00	5.00	0.00	0.40			
17	B	714.44	600.37	6.00	293.00	5.00	0.00	0.40			
18	B	732.22	612.05	6.00	309.00	5.00	0.00	0.40			
19	B	752.96	635.81	6.00	313.00	5.00	0.00	0.40			
20	B	769.16	655.23	6.00	310.00	5.00	0.00	0.40			
21	B	785.16	674.94	6.00	320.00	5.00	0.00	0.40			
22	B	798.82	697.10	6.00	327.00	5.00	0.00	0.40			
23	B	745.99	641.14	6.00	190.00	5.00	0.00	0.40			
24	B	742.93	660.77	6.00	194.00	5.00	0.00	0.40			
25	B	739.57	683.22	6.00	195.00	5.00	0.00	0.40			
26	B	736.60	704.20	6.00	193.00	5.00	0.00	0.40			
27	B	721.90	728.79	6.00	325.00	5.00	0.00	0.40			
28	B	829.33	578.35	6.00	355.00	5.00	0.00	0.40			
29	B	832.41	597.66	6.00	354.00	5.00	0.00	0.40			
30	B	845.44	631.52	6.00	333.00	5.00	0.00	0.40			
31	B	854.40	645.90	6.00	328.00	5.00	0.00	0.40			
32	B	834.48	617.46	6.00	337.00	5.00	0.00	0.40			
33	B	811.74	718.23	6.00	329.00	5.00	0.00	0.40			
34	B	825.87	740.22	6.00	329.00	5.00	0.00	0.40			
35	B	836.12	755.44	6.00	322.00	5.00	0.00	0.40			
36	A	866.81	796.65	6.00	340.00	5.00	0.00	0.40			
37	A	888.75	812.34	6.00	257.00	5.00	0.00	0.40			
38	B	874.24	760.81	6.00	74.00	5.00	0.00	0.40			
39	B	905.33	753.81	6.00	91.00	5.00	0.00	0.40			
40	B	920.93	921.00	6.00	355.00	5.00	0.00	0.40			
41	B	928.74	953.89	6.00	347.00	5.00	0.00	0.40			
42	D	928.28	988.31	8.00	251.00	5.00	0.00	0.40			
43	A	726.54	742.35	6.00	63.00	5.00	0.00	0.40			
44	C	756.83	742.77	5.00	236.00	0.00	0.00	0.00			
45	C	761.11	726.43	5.00	46.00	0.00	0.00	0.00			

Layout Continued

ID	Type	X	Y	Height	Angle	Tilt	Cant	Out-reach	Target X	Target Y	Target Z
46	C	783.52	724.97	5.00	223.00	0.00	0.00	0.00			
47	C	791.69	707.32	5.00	71.00	0.00	0.00	0.00			
48	C	809.17	708.22	5.00	278.00	0.00	0.00	0.00			
49	C	864.86	659.27	5.00	61.00	0.00	0.00	0.00			
50	C	814.70	694.10	5.00	112.00	0.00	0.00	0.00			
51	C	832.01	691.58	5.00	231.00	0.00	0.00	0.00			
52	C	834.84	677.13	5.00	56.00	0.00	0.00	0.00			
53	C	855.43	675.57	5.00	221.00	0.00	0.00	0.00			
54	C	885.10	656.13	5.00	242.00	0.00	0.00	0.00			
55	C	891.39	642.06	5.00	55.00	0.00	0.00	0.00			
56	C	911.31	639.46	5.00	240.00	0.00	0.00	0.00			
57	C	923.11	635.89	5.00	292.00	0.00	0.00	0.00			
58	C	931.77	615.75	5.00	65.00	0.00	0.00	0.00			
59	A	770.36	805.04	6.00	242.00	5.00	0.00	0.40			
60	A	780.99	820.52	6.00	163.00	5.00	0.00	0.40			
61	A	775.92	790.57	6.00	154.00	5.00	0.00	0.40			
62	A	759.94	763.11	6.00	147.00	5.00	0.00	0.40			
63	A	754.75	782.14	6.00	319.00	5.00	0.00	0.40			
64	B	1034.97	848.25	6.00	186.00	5.00	0.00	0.40			
65	C	899.13	626.17	5.00	355.00	0.00	0.00	0.00			
66	C	890.51	613.35	5.00	355.00	0.00	0.00	0.00			
67	C	881.88	597.31	5.00	355.00	0.00	0.00	0.00			
68	C	877.68	580.17	5.00	236.00	0.00	0.00	0.00			
69	C	743.62	741.84	5.00	56.00	0.00	0.00	0.00			
70	B	909.00	887.78	6.00	345.00	5.00	0.00	0.40			
71	B	902.49	851.89	6.00	355.00	5.00	0.00	0.40			
72	B	896.61	831.15	6.00	343.00	5.00	0.00	0.40			
73	A	893.98	866.30	6.00	76.00	5.00	0.00	0.40			
74	A	913.35	805.23	6.00	257.00	5.00	0.00	0.40			
75	A	923.15	774.25	6.00	183.00	5.00	0.00	0.40			
87	B	698.85	711.89	6.00	289.00	5.00	0.00	0.40			
88	C	878.87	989.36	5.00	59.00	0.00	0.00	0.00			
89	C	895.87	967.62	5.00	278.00	0.00	0.00	0.00			
90	B	892.41	1084.98	6.00	254.00	5.00	0.00	0.40			
91	A	835.96	1068.04	6.00	341.00	5.00	0.00	0.40			
92	D	907.86	1059.23	8.00	156.00	5.00	0.00	0.40			

Layout Continued

ID	Type	X	Y	Height	Angle	Tilt	Cant	Out-reach	Target X	Target Y	Target Z
93	D	905.49	1025.00	8.00	197.00	5.00	0.00	0.40			
94	D	958.38	980.37	8.00	274.00	5.00	0.00	0.40			
95	D	984.59	987.90	8.00	303.00	5.00	0.00	0.40			
96	D	1002.20	1004.45	8.00	321.00	5.00	0.00	0.40			
97	D	1012.23	1026.00	8.00	337.00	5.00	0.00	0.40			
98	D	1018.91	1046.90	8.00	346.00	5.00	0.00	0.40			
99	B	870.89	1090.97	6.00	254.00	5.00	0.00	0.40			
100	B	1018.42	987.82	6.00	225.00	5.00	0.00	0.40			
101	B	1029.82	958.57	6.00	188.00	5.00	0.00	0.40			
102	B	1030.88	931.06	6.00	189.00	5.00	0.00	0.40			
103	B	1032.19	901.45	6.00	185.00	5.00	0.00	0.40			
104	B	1035.37	878.01	6.00	182.00	5.00	0.00	0.40			
105	B	1046.20	873.34	6.00	275.00	5.00	0.00	0.40			
106	B	1056.58	878.92	6.00	6.00	5.00	0.00	0.40			
107	B	1090.74	876.85	6.00	176.00	5.00	0.00	0.40			
108	B	1083.71	856.33	6.00	98.00	5.00	0.00	0.40			
109	B	1092.66	830.71	6.00	156.00	5.00	0.00	0.40			
110	B	1059.96	839.78	6.00	272.00	5.00	0.00	0.40			
111	B	1065.25	766.31	6.00	98.00	5.00	0.00	0.40			
112	B	1084.80	766.82	6.00	97.00	5.00	0.00	0.40			
113	B	1089.22	805.57	6.00	177.00	5.00	0.00	0.40			
114	B	1051.94	805.08	6.00	7.00	5.00	0.00	0.40			
115	B	1037.87	964.33	6.00	76.00	5.00	0.00	0.40			
116	B	1065.59	955.97	6.00	69.00	5.00	0.00	0.40			
117	B	1084.22	956.06	6.00	156.00	5.00	0.00	0.40			
118	B	1080.00	990.42	6.00	181.00	5.00	0.00	0.40			
119	B	1076.40	1016.56	6.00	179.00	5.00	0.00	0.40			
120	B	1035.62	824.20	6.00	186.00	5.00	0.00	0.40			
121	B	1036.60	798.84	6.00	181.00	5.00	0.00	0.40			
122	B	1037.91	773.64	6.00	185.00	5.00	0.00	0.40			
123	B	927.72	838.60	6.00	258.00	5.00	0.00	0.40			
124	B	956.36	838.60	6.00	275.00	5.00	0.00	0.40			
125	B	985.29	840.46	6.00	275.00	5.00	0.00	0.40			
126	B	1013.35	842.04	6.00	275.00	5.00	0.00	0.40			
127	B	1049.11	749.70	6.00	275.00	5.00	0.00	0.40			
128	B	1081.01	746.44	6.00	268.00	5.00	0.00	0.40			

Horizontal Illuminance (lux)

Grid 1

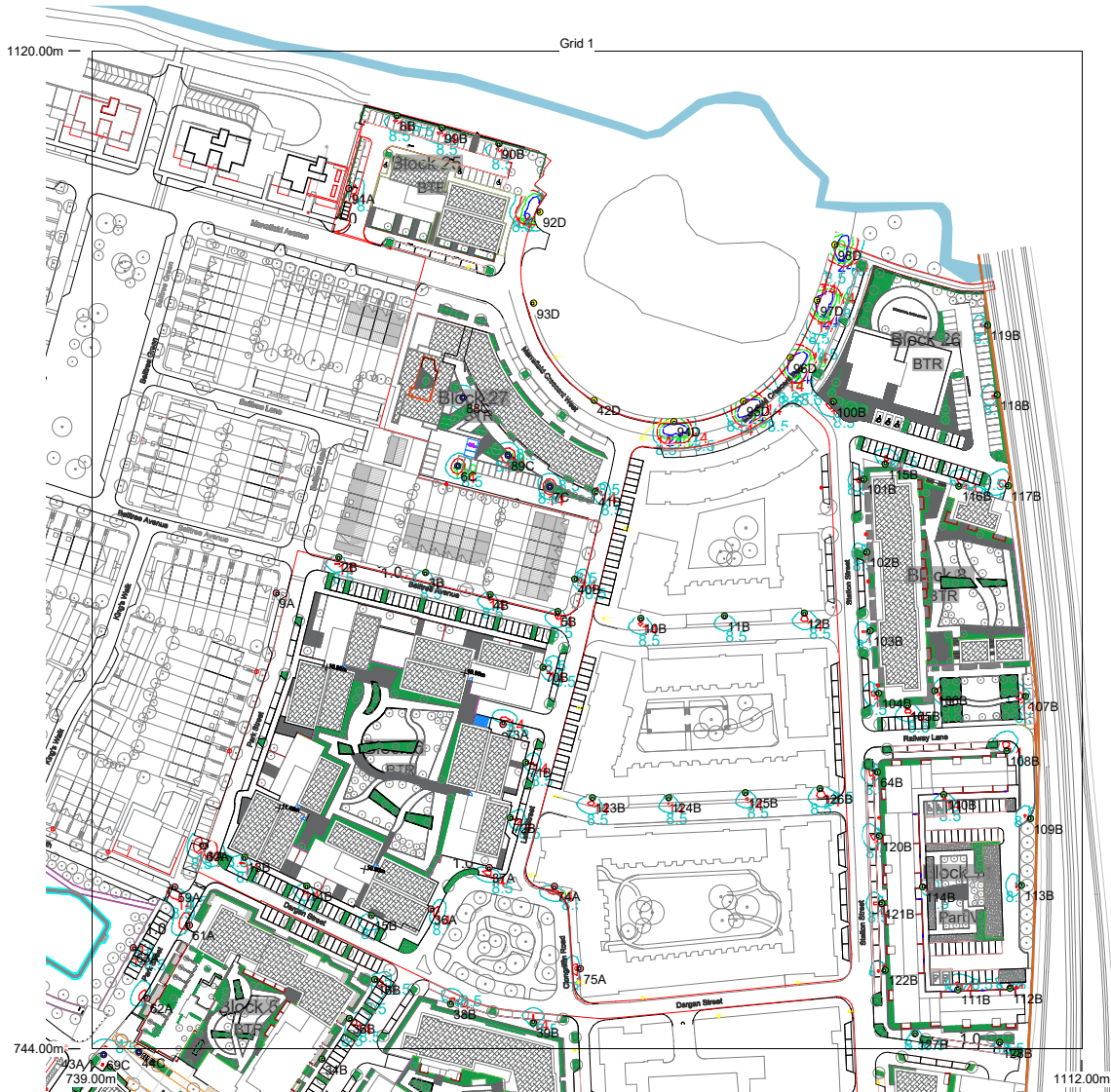

Results

Eav	5.58
Emin	0.94
Emax	31.13
Emin/Emax	0.03
Emin/Eav	0.17

Horizontal Illuminance (lux)

Grid 1



Results

Eav	5.58
Emin	0.94
Emax	31.13
Emin/Emax	0.03
Emin/Eav	0.17

Horizontal Illuminance (lux)

Grid 2

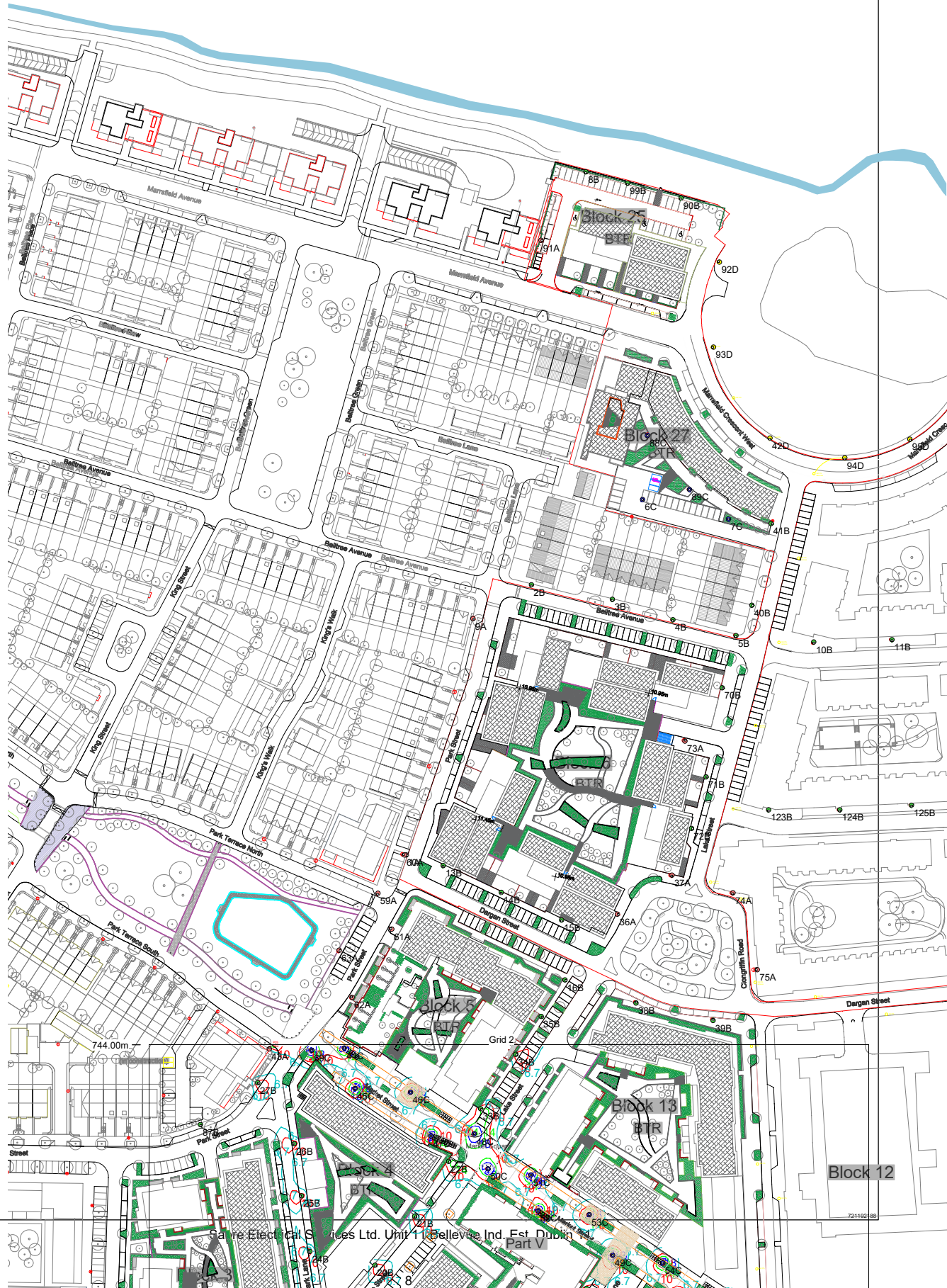

Horizontal Illuminance (lux)

Grid 2

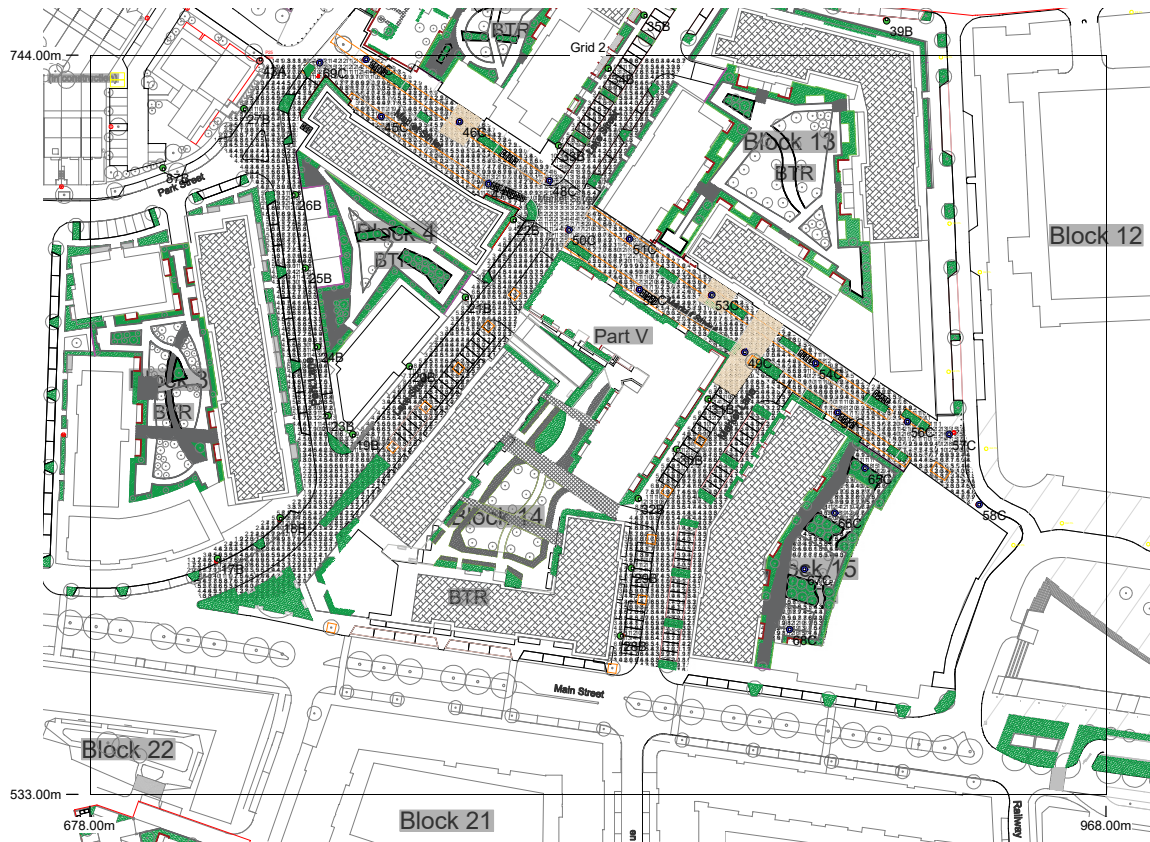

Results

Eav	6.52
Emin	1.06
Emax	23.73
Emin/Emax	0.04
Emin/Eav	0.16